

con più di meno - to tut - to ce

LA - SI - MI - / / - MI - / /

miò folle mio ne Lo soffre il cielo
 miò folle mio ne Lo soffre il cielo

MI - LA - / / - MI - / /

LO SOFFIA IL CIELO

...così

FIRST OF ALL YOU ARE, AND MUST BE, VERY PRETTY. NOT PERHAPS IN THE CONVENTIONAL SENSE. IN BUILD YOU CAN BE SMALL AND INDEED EVEN A LITTLE SKINNY; YOUR FEATURES CAN ALREADY SHOW THE MARKS WHICH WITH THE YEARS WILL INEVITABLY TURN YOUR FACE INTO A MASK. BUT YOUR EYES MUST BE BLACK AND SHINING; YOUR MOUTH A LITTLE WIDE; YOUR FACE FAIRLY REGULAR; YOUR HAIR MUST BE SHORT AT THE NECK AND BEHIND THE EARS; WHEREAS ON YOUR BROW I HAVE NO DIFFICULTY IN GRANTING YOU A FINE QUAFF, HIGH, WARLIKE AND PERHAPS A LITTLE EXAGGERATED AND RIDICULOUS. I WOULD NOT MIND IF YOU WERE A BIT OF A SPORTSMAN AND THEREFORE SLIM IN THE HIPS AND SOLID IN THE LEGS. AS FOR THE SPORT, I WOULD PREFER YOU TO LIKE SOCCER SO THAT NOW AND AGAIN WE CAN HAVE A GAME TOGETHER. AND ALL THIS – ALL THIS ABOUT YOUR BODY – LET US BE CLEAR, HAS NOT IN YOUR CASE ANY PRACTICAL OR INTERESTED AIM; IT IS A PURE AESTHETIC THOUGHT, ONE MOREOVER THAT PUTS ME AT EASE. LET US UNDERSTAND EACH OTHER: IF YOU WERE UGLY, REALLY UGLY, IT WOULD ALL THE SAME PROVIDED YOU WERE AS LIKEABLE AND NORMALLY INTELLIGENT AND AFFECTIONATE AS YOU ARE. IN THAT CASE IT IS ENOUGH IF YOUR EYES ARE LAUGHING – JUST AS IF INSTEAD OF BEING A

GENNARIELLO YOU WERE A CONCETTINA.

tutorialdiversions.org & Zwielight are pleased to present

Lo soffia il cielo...così

A trans Pavilion, Rosenthalerstr. 40/41, 10178 Berlin

Saturday, June 27th, 2009, at 20:34

Public demonstration with Bill **DIETZ** & Sebastian **BISKUP**

Lo soffia il cielo...così is a Tutorial Diversion for use in domestic listening situations.

Lo soffia il cielo...così is a ‘dolly zoom’ between the Lido di Ostia, Fall 1975, and Clichy-sous-Bois, Fall 2005.

Lo soffia il cielo...così must be performed with one of the 4 audio profiles available from tutorialdiversions.org/soffia.html or with a profile generated by *Lo soffia*’s accompanying profiling software (currently in development).

Realization of *Lo soffia il cielo...così*
is constituted by:

1. Loudspeaker Setup
2. Acquisition/Generation of Audio Profile(s)
3. Audio Profile Playback with Approach

1. LOUDSPEAKER SETUP

Lo soffia il cielo...così requires a single sound source (loudspeaker) for performance. Multiple loudspeakers must either be positioned as close as possible together (Fig. 1), or all but one loudspeaker should be disconnected.

Before adjusting your Home Setup remember to document & submit it to tutorialdiversions.org/homesetup.html!

The single sound source may be positioned anywhere within your domestic listening space, though tutorialdiversions.org suggests that for your first performance, the sound source be positioned at a significant distance from your listening position.

Fig. 1

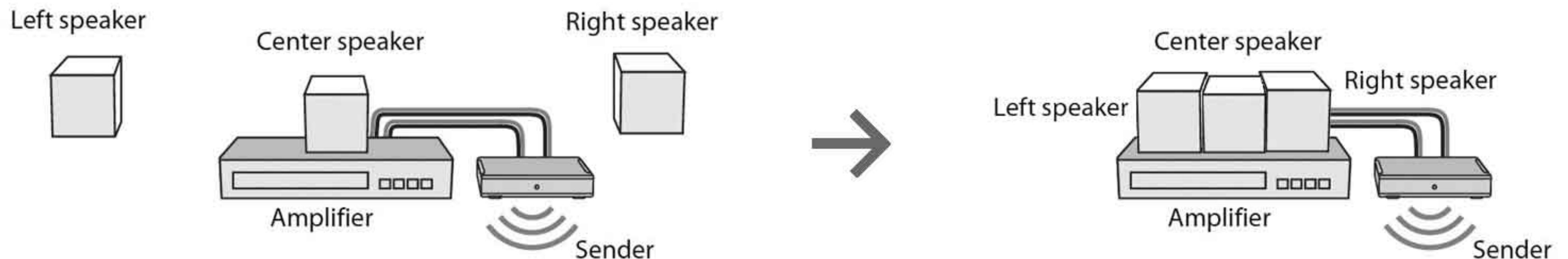

2. ACQUISITION/GENERATION OF AUDIO PROFILE(S)

4 Audio Profiles (2 continuous Profiles, 2 phrased Profiles) designed for use with *Lo soffia il cielo...così* are available for download from tutorialdiversions.org/soffia.html. Dependent upon your preferred method of playback, the individual audio files that make up these profiles may need to be transferred to a physical medium (CD or DVD).

The generation of further Audio Profiles based upon your own preferred source material will soon be possible via profiling software (currently in development).

All Audio Profiles for *Lo soffia il cielo...così* are intercut with a specific “G-BEE” (Global Beeliner) from the G-TURNS Online Store (g-turns.com). The exemplary Profiles available from tutorialdiversions.org are based upon Monsieur R’s *FranSSe* (2005) and Domenico Modugno & Pier Paolo Pasolini’s *Che cosa sono le nuvole?* (1967).

3. AUDIO PROFILE PLAYBACK WITH APPROACH

Performance of *Lo soffia il cielo...così* is constituted by a Listener's approach to a sound source (loudspeaker) during playback (of an Audio Profile) at such a rate that as little difference in loudness as possible is perceived.

Perceived loudness of a given Audio Profile should remain as static as possible during playback. The Profiles specifically designed for *Lo soffia il cielo...così* are made to allow for this.

Practically, this means that as soon as playback of an Audio Profile begins, the Listener (positioned a significant distance from the sound source) begins to approach the sound source (Fig. 2). The speed of approach should be such that the Listener arrives at the sound source precisely as the playback of a given Audio Profile comes to an end. In the case of the 2 exemplary continuous Profiles (each of which lasts more than 4 minutes), this means the Listener (dependent on the size of her or his domestic listening space) must approach the sound source extremely slowly - perhaps even stopping between individual, small

steps. The precise rate of approach can only be determined by listening. The rate of approach is correct insofar as the perceived loudness of a given Audio Profile remains unchanged throughout its playback.

In the case of the 2 exemplary phrased Profiles (each of which is divided into multiple sections of various lengths), the Listener must approach the sound source at various speeds - perhaps in one phrase sprinting across the listening space, and in another, once again stopping between individual steps. Again, correct rate of approach can only be judged insofar as the perceived loudness of a given Profile or Profile phrase remains unchanged throughout its playback.

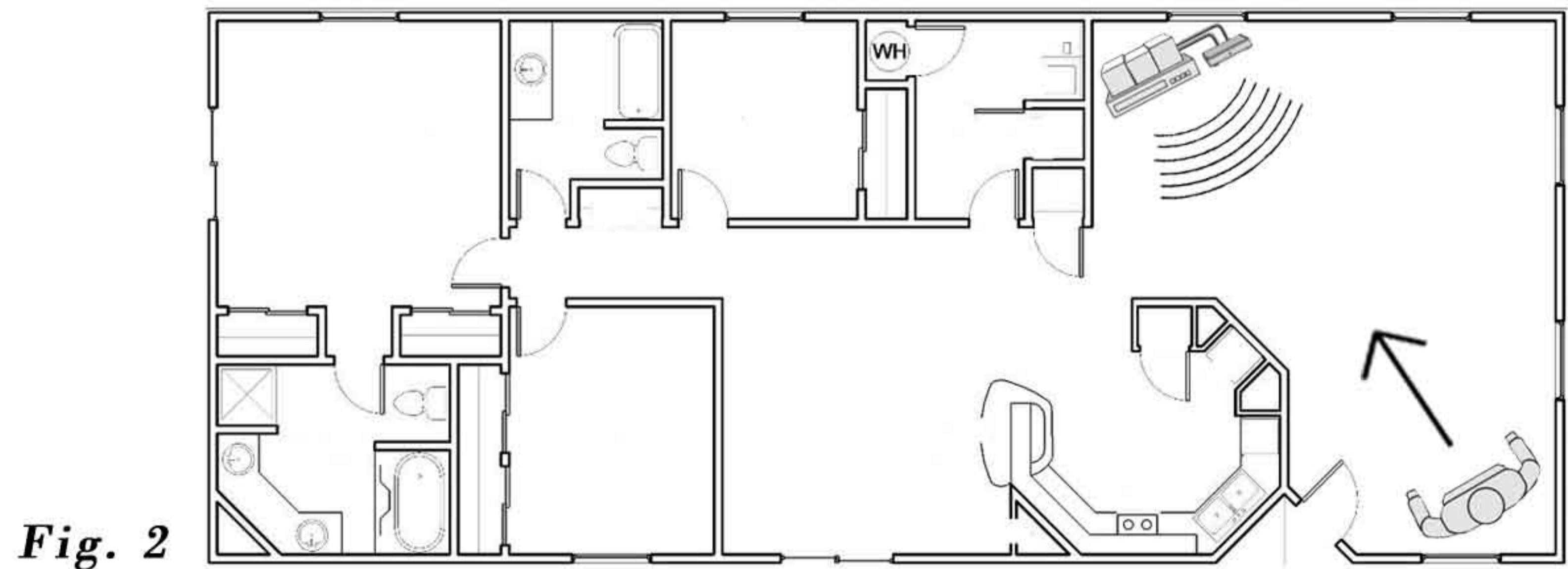

Fig. 2

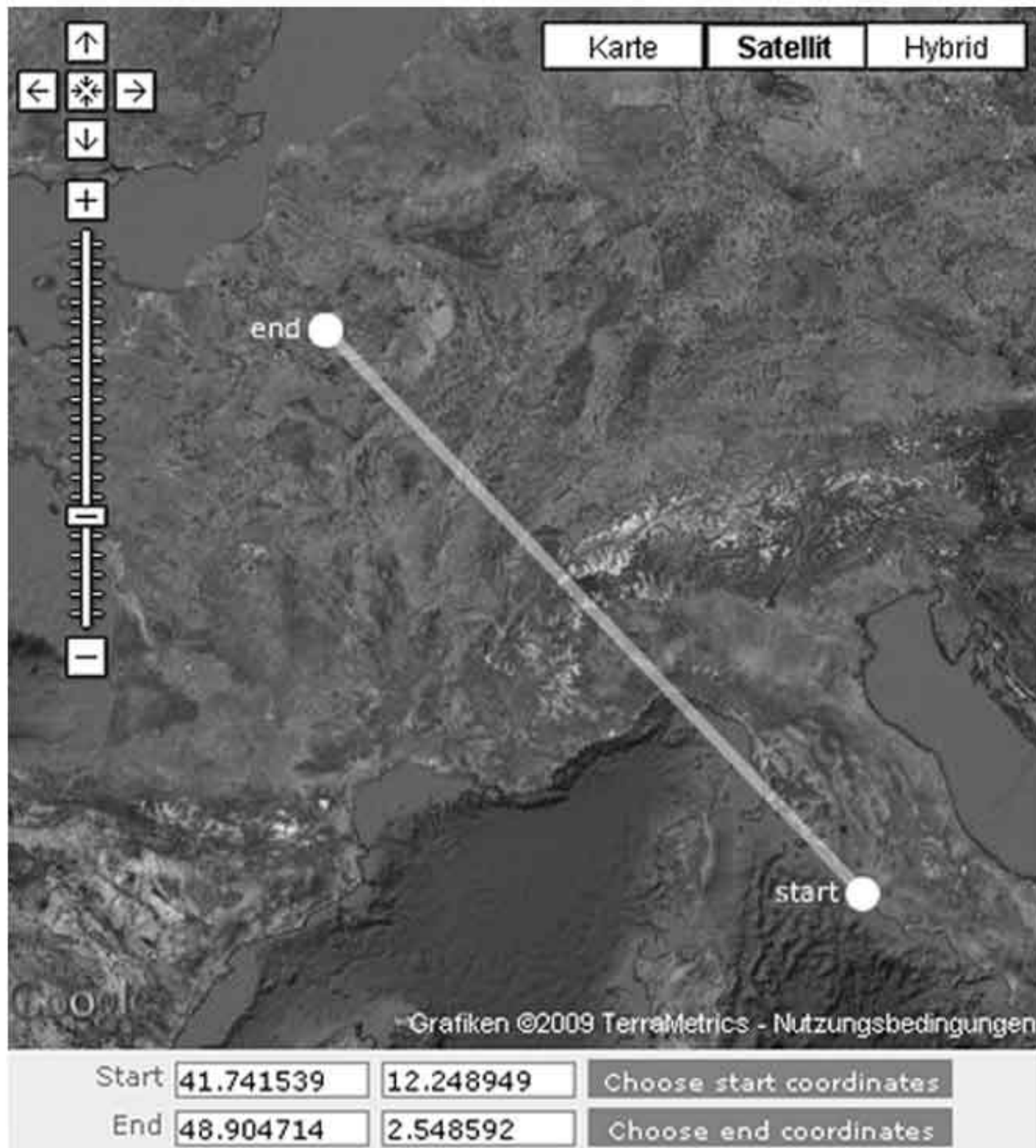

Fig. 3

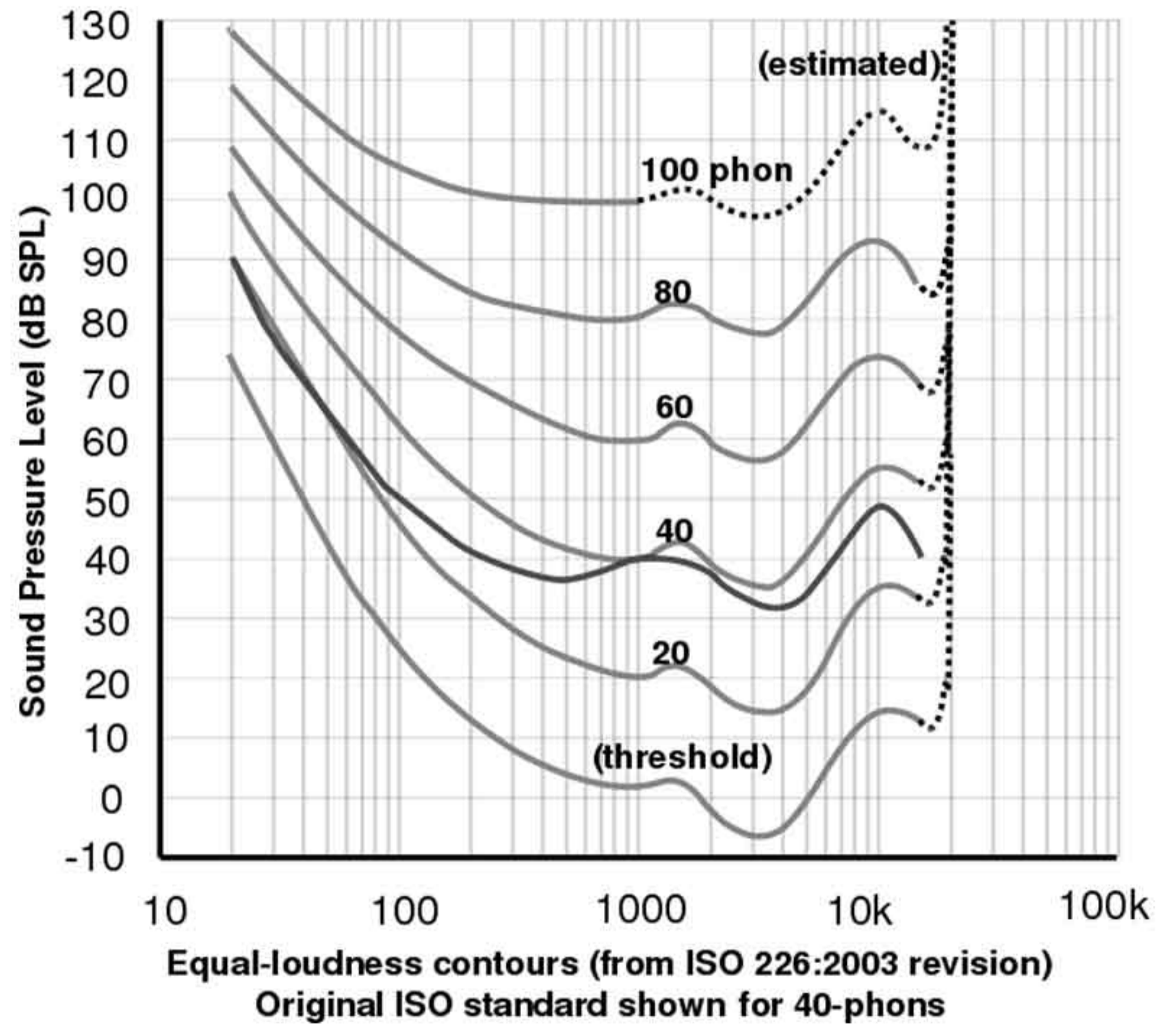

Fig. 4

NOTES

- As there are no pauses built into the Audio Profiles, it is recommended that the playback of each Profile and Profile phrase be initiated separately.
- Depending upon your Home Setup, it may be necessary to use a remote control or to seek assistance from another Listener when initiating playback of individual Profiles and Profile phrases.
- With a second Listener, each Profile's potential for reversibility may also be realized. One Listener remains stationary & listens while the other Listener approaches her or him carrying the sound source (loudspeaker). The carrying Listener approaches at such a rate that the listening Listener perceives no change in loudness in the Audio Profile. In this case, the rate may or must be regulated gesturally or vocally by the listening Listener.

Many thanks to

Marc **SABAT**, Mareike **LEE**,
Isolde **NAGEL**, Anne **METZEN**,
Sebastian **BISKUP** & Jens **BRAND**

Lo soffia il cielo...così
2006 - 2009

MONSIEUR
ER